

NEW

Elcometer 135C Bresle Test Patch

elcometer®
inspection equipment

Determines the level of **soluble salts on uncoated surfaces** using the **patch method** in accordance with **ISO 8502-6**

- Easy to remove after test, leaving no foam - ideal for use in the field

- Self adhesive rubber film patches with thick foam surround, easy to insert needle

- Supplied with Certificate of Cleanliness for peace of mind

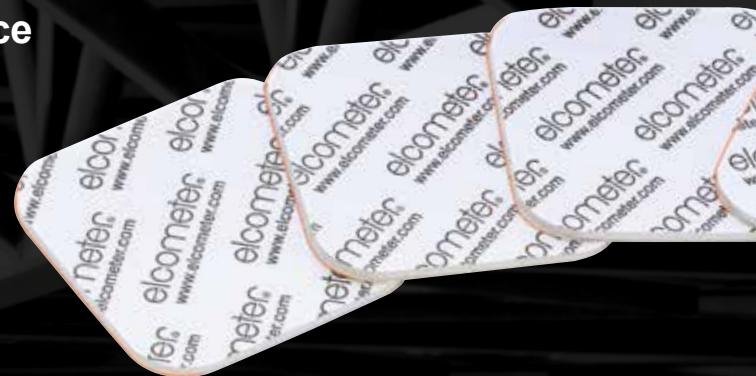

Elcometer 135C

Elcometer Bresle Test Patch

The Elcometer 135C Bresle Test Patch determines the concentration of soluble salts on uncoated surfaces in accordance with the ISO 8502-6 test method.

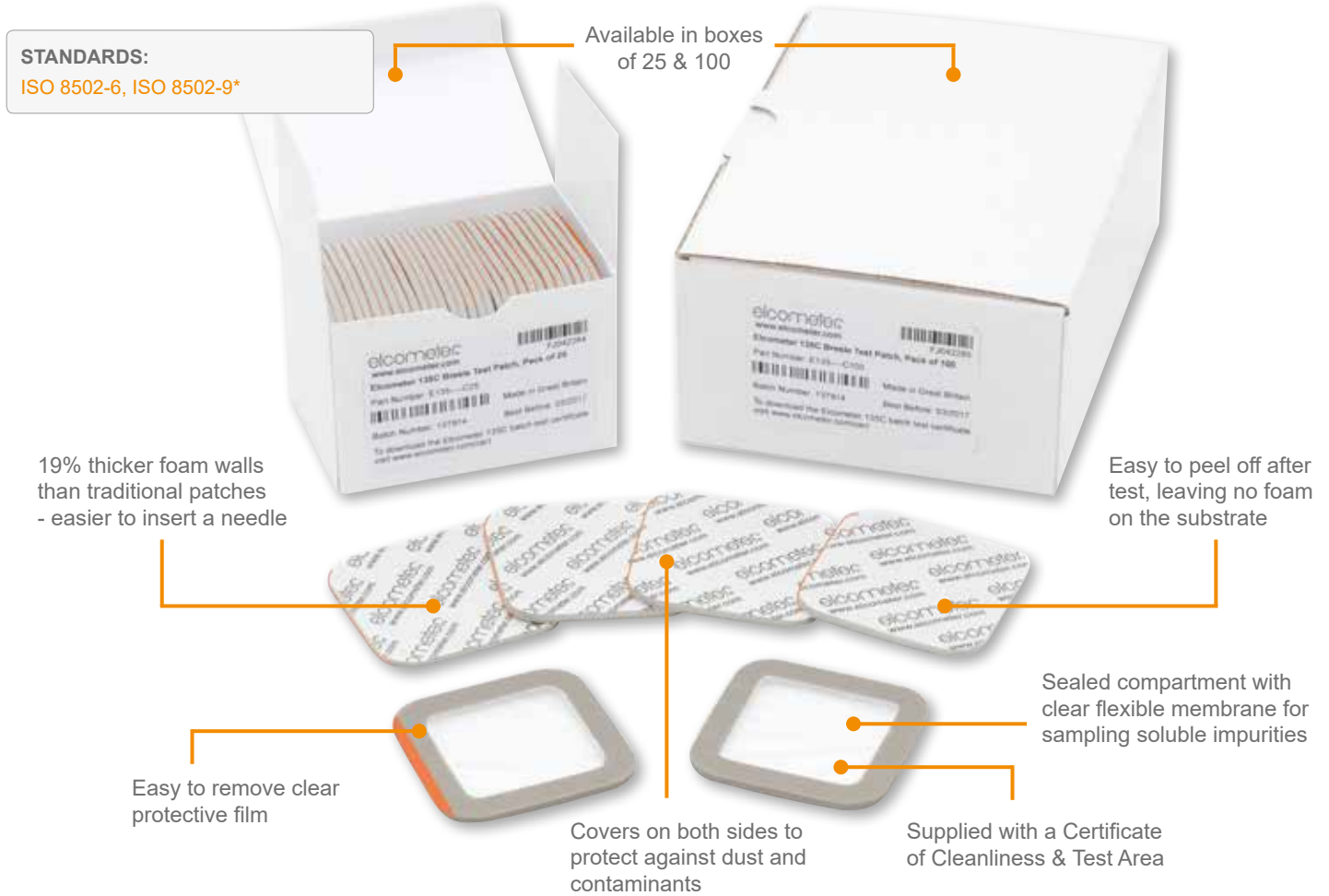

Measuring salt contamination using the Bresle method in accordance with ISO 8502-6/ISO 8502-9

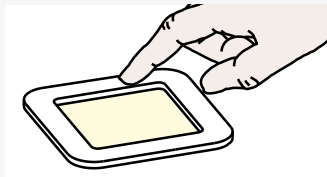

Remove protective backing and foam centre from the patch.

Apply the patch to surface and press firmly around perimeter to achieve a complete seal - ensuring that a minimum amount of air is trapped within the test compartment.

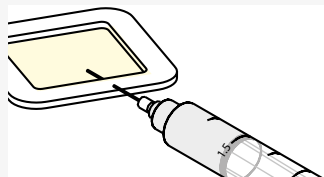

Fill the syringe with 3.0ml of pure water. Insert the syringe into the patch through its foam perimeter, at a 30° angle, so that it passes through the foam into the test compartment.

Inject the water into the test compartment. If necessary remove the remaining air within the compartment.

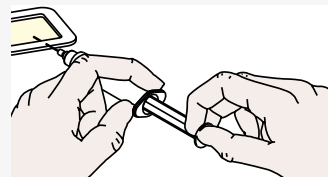

During an agreed period of time, without removing the needle - withdraw and re-inject the solution back into the patch, at least four times.

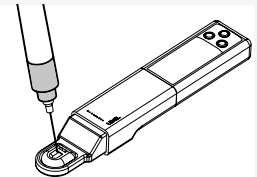

At the end of the period extract as much solution as possible.

Remove the syringe from the patch and measure the conductivity of the solution using a suitable Conductivity Meter such as the Elcometer 138.

* When used in conjunction with an Elcometer 138 Conductivity Meter

Elcometer Bresle Test Patch

Elcometer 135C

“No foam residue”



Elcometer 135C Bresle Test Patches are easy to peel off after a test, leaving no foam on the substrate, causing less damage as no need to scrape off residue.

“Easy to insert the syringe”



The new Elcometer 135C Bresle Test Patches have a thicker foam surround compared to traditional patches, allowing easier insertion of the syringe.

“Water-tight seal”



Robust & durable the new Elcometer 135C patches use a high quality adhesive, ensuring a water-tight seal during test.

“Certified for peace of mind”



The Elcometer 135C Bresle Test Patches are available with a Batch Certificate of Cleanliness & Test Area in accordance with ISO 8502-6.

Technical Specification

Part Number	Description	Certificate*
E135---C25	Elcometer 135C Bresle Test Patch (Box of 25)	●
E135---C100	Elcometer 135C Bresle Test Patch (Box of 100)	●
Test Area	1250mm ² , 12.5cm ² (1.93sq inches)	
Sample Volume	2.6ml ± 0.6ml	
Dimensions	50 x 50mm (1.97 x 1.97")	

Accessories

T13823925	Elcometer 138 Conductivity Meter
T13827259	Pure Water, 250ml (8.5fl oz) Bottle
T13823926	Standard 1.41 mS/cm (1410 µS/cm) Calibration Solution – 6 x 14ml (0.47fl oz) Bottles
T13818517	3 x 5ml (0.17fl oz) Syringes
T13818518	3 x Needles
T13818519	Plastic Beaker, 30ml (1fl oz)

● Certificate of Cleanliness & Test Area available at www.elcometer.com/cert

* Elcometer 135C Bresle Test Patches are available with your logo, contact your Elcometer representative for more information.

Elcometer 138



STANDARDS:
 AS 3894.6-A, IMO MSC.215 (82),
 IMO MSC.244 (83), ISO 8502-6,
 ISO 8502-9, SSPC Guide 15,
 US Navy NSI 009-32,
 US Navy PPI 63101-000

Bresle Salt Kit

It is essential that the level of contaminants on a surface is measured prior to application of the coating to ensure the quality of the coating and that its optimum lifetime is achieved.

If the coating is applied to a contaminated surface, which is not properly prepared, it could fail prematurely resulting in costly re-coating and high maintenance costs.

The Elcometer 138 Bresle Kit includes the Elcometer 138 Conductivity Meter. This lightweight, portable conductivity meter accurately measures the salinity of the test samples.

The sensor cartridge can be easily replaced when necessary and displays conductivity in a range of units including: S/cm, S/m, ppm and % salinity.

Technical Specification C			
Part Number	Description	Certificate	
E138-1C	Elcometer 138 Bresle Salt Kit with Elcometer 135C Bresle Test Patches	●	
Measurement Range	0 mS/cm to 19.9 mS/cm and 0 S/m to 1.99 S/m	Accuracy*	2% full scale ±1 digit
Dimensions	346 x 292 x 84mm (13.6 x 11.5 x 3.3")	Weight	1.1kg (2lb 7oz)
Packing List	Box of 25 Elcometer 135C Bresle Test Patches, Elcometer 138 Conductivity Meter & Sensor, 14ml (0.47fl oz) bottle of standard 1.41 mS/cm calibration solution, 14ml (0.47fl oz) bottle of moistening solution, 250ml (8.5fl oz) bottle of pure water, 3 x 5ml (0.17fl oz) syringes, 3 x blunt needles, 30ml (1fl oz) plastic beaker, 2 x CR2032 batteries, transit case and user guide		

Elcometer 138B



STANDARDS:
 AS 3894.6-A, IMO MSC.215 (82),
 IMO MSC.244 (83), ISO 8502-6,
 ISO 8502-9, SSPC Guide 15,
 US Navy NSI 009-32,
 US Navy PPI 63101-000

Basic Bresle Salt Kit

If a coating is applied to a contaminated surface, which is not properly prepared, it could fail prematurely resulting in costly re-coating and high maintenance costs.

Therefore it is essential to measure the level of contaminants on a surface prior to coating application to ensure the quality of the coating and that its optimum lifetime is achieved.

The Elcometer 138 Basic Bresle Kit includes the Elcometer 135C Bresle Test Patches and the Elcometer 138E Conductivity Meter. This lightweight, portable conductivity meter accurately measures the salinity of the test samples.

The sensor cartridge can be easily replaced when necessary and displays conductivity in a range of units including: S/cm & S/m.

Technical Specification C			
Part Number	Description	Certificate	
E138-EC	Elcometer 138 Basic Bresle Salt Kit with Elcometer 135C Bresle Test Patches	●	
Measurement Range	0 μS/cm to 200.0 μS/cm, 0 μS/cm to 2000 μS/cm, 0 mS/cm to 20.00 mS/cm		
Accuracy#	± 1% of full scale		
Dimensions	307 x 260 x 74mm (12.1 x 10.2 x 2.9")	Weight	952g (2lb 1oz)
Packing List	Box of 25 Elcometer 135C Bresle Test Patches, Elcometer 138E Conductivity Meter, 250ml (8.5fl oz) bottle of pure distilled water, 3 x 3ml (0.1fl oz) syringes, 3 x blunt needles, 1 x 20ml Standard 1413μS/cm (1.413mS/cm) Calibration Solution, 30ml (1fl oz) plastic beaker, 4 x 1.5V batteries, transit case & user guide		

● Certificate of Cleanliness & Test Area available at www.elcometer.com/cert *See Elcometer 138 Conductivity Meter for full specification
 # See Elcometer 138E for full specification

Conductivity Meter

Elcometer 138

Incorporating a flat sensor, the Elcometer 138 Conductivity Meter can measure the conductivity of a solution from a single drop of a sample.

Users can either place a sample on the meter's flat sensor or immerse the meter's sensor directly into the solution under test. The Elcometer 138 can be used for a broad range of applications, including: soluble salt concentrations, the electric conductivity (EC) of solutions used in agricultural operations and measuring rainwater pollution levels.

The Elcometer 138 Conductivity Meter includes a convenient salinity conversion indicator.

Features:

- Highly precise measurements can be obtained from a single drop
- Automatic range switching gives a wide measurement range of 1µS/cm to 19.9mS/cm
- Out of range and low battery alarms
- Visual indication when ambient temperature is outside the operating range



Technical Specification

Part Number	Description		
T13823925	Elcometer 138 Conductivity Meter		
Units	S/cm, S/m, % Salinity, ppm (Total Dissolved Salts - TDS)		
Measuring Range	Conductivity:	0 mS/cm to 19.9 mS/cm, 0 S/m to 1.99 S/m	
	Salt:	0% to 1.1%	
	TDS:	0 ppm to 9900 ppm	
Resolution & Accuracy		Resolution	Accuracy
	0 µS/cm to 199 µS/cm:	1 µS/cm	± 5 µS/cm
	0.20 mS/cm to 1.99 mS/cm:	0.01 mS/cm	± 0.05 mS/cm
	2.0 mS/cm to 19.9 mS/cm:	0.1 mS/cm	± 0.5 mS/cm
	20 mS/cm to 199 mS/cm:	1 mS/cm	± 5 mS/cm
Operating Temperature	5°C to 40°C (41°F to 104°F)		
Power Supply	2 x CR2032 batteries	Battery Life	approx. 400 hours of continuous use
Dimensions	164 x 29 x 20mm (6.5 x 1.2 x 0.8")	Weight	47g (1.7oz)
Packing List	Elcometer 138, 14ml (0.47fl oz) bottle of standard 1.41mS/cm calibration solution, 14ml (0.47fl oz) bottle of moistening solution, 2 x CR2032 batteries and operating instructions		

Accessories

E135----C25	Elcometer 135C Bresle Test Patch (Box of 25)	T13823928	Replacement Conductivity Sensor
E135----C100	Elcometer 135C Bresle Test Patch (Box of 100)	T13818517	3 x 5ml (0.17fl oz) Syringes
T13818518	3 x Needles	T13818519	Plastic Beaker 30ml (1fl oz)
T13827352-1	Standard 447 µS/cm (0.447 mS/cm) Calibration Solution – 4 x 20ml (0.74fl oz) Single Use Pouches		
T13827352-2	Standard 1413 µS/cm (1.413 mS/cm) Calibration Solution – 4 x 20ml (0.74fl oz) Single Use Pouches		
T13827352-3	Standard 15000 µS/cm (15 mS/cm) Calibration Solution – 4 x 20ml (0.74fl oz) Single Use Pouches		
T13823926	Standard 1.41 mS/cm (1410 µS/cm) Calibration Solution – 6 x 14ml (0.47fl oz) Bottles		
T13824404	Standard 12.9 mS/cm (12900 µS/cm) Calibration Solution – 6 x 14ml (0.47fl oz) Bottles		
T13827259	Pure Water 250ml (8.5fl oz) Bottle		

Elcometer 138E

Conductivity Meter



Incorporating a cup-style sensor, the Elcometer 138E Conductivity Meter can measure the conductivity of a solution from a few drops of a sample.

Users can either place a sample on the meter's sensor or immerse the meter's sensor directly into the solution under test. The Elcometer 138E is suitable for a broad range of applications, including: soluble salt concentrations, the electric conductivity (EC) of solutions.

Features:

- Automatic range switching gives a wide measurement range of 0 μ S/cm to 20mS/cm
- Out of range and low battery indicators
- Automatic temperature compensation (ATC) and manual or automatic one or two-point calibration
- LCD screen with indicators and error messages, dual-line display
- User-replaceable integrated 2-pin, stainless steel electrode provides chemical resistance

Technical Specification

Part Number	Description		
T13827355	Elcometer 138E Conductivity Meter		
Measurement Principle	2 AC Bipolar Method		
Sensor Type	Cup		
Units	μ S/cm, mS/cm		
Measuring Range & Resolution	PU: 0 - 200.0 μ S/cm	0.1 μ S/cm	
	LO: 0 - 2000 μ S/cm	1 μ S/cm	
	HI: 0 - 20mS/cm	0.01mS/cm	
Accuracy	\pm 1% of full scale		
LCD Display	Custom Dual Display; 27 x 21mm (1.06 x 0.83")		
Operating Temperature	0°C to 50°C (32°F to 122°F)		
Power Supply	4 x 1.5V LR44 batteries	Battery Life	>150 hours
Dimensions	165 x 38mm (6.5 x 1.5")	Weight	90g (3.2oz) - including batteries
Packing List	Elcometer 138E, 4 x 1.5V LR44 batteries and operating instructions		

Accessories

E135----C25	Elcometer 135C Bresle Test Patch (Pack of 25)
E135----C100	Elcometer 135C Bresle Test Patch (Box of 100)
T13827352-1	Standard 447 μ S/cm (0.447 mS/cm) Calibration Solution – 4 x 20ml (0.74fl oz) Single Use Pouches
T13827352-2	Standard 1413 μ S/cm (1.413 mS/cm) Calibration Solution – 4 x 20ml (0.74fl oz) Single Use Pouches
T13827352-3	Standard 15000 μ S/cm (15 mS/cm) Calibration Solution – 4 x 20ml (0.74fl oz) Single Use Pouches
T13823926	Standard 1.41 mS/cm (1410 μ S/cm) Calibration Solution – 6 x 14ml (0.47fl oz) Bottles
T13824404	Standard 12.9 mS/cm (12900 μ S/cm) Calibration Solution – 6 x 14ml (0.47fl oz) Bottles
T13827259	Pure Distilled Water 250ml (8.5fl oz) Bottle

Elcometer Bresle Test Patches

The Elcometer 135C Bresle Test Patch determines the concentration of soluble salts on uncoated surfaces in accordance with the ISO 8502-6 test method.

Elcometer Bresle Test Patches are also available as part of the Elcometer 138 Bresle Salt Kit.

Elcometer 135C



STANDARDS:
ISO 8502-6

Technical Specification

C

Part Number	Description	Certificate	
E135----C25	Elcometer 135C Bresle Test Patch (Box of 25)	•	
E135----C100	Elcometer 135C Bresle Test Patch (Box of 100)	•	
Test Area	1250mm ² , 12.5cm ² (1.93sq inches)	Sample Volume	2.6ml ± 0.6ml
Dimensions	50 x 50mm (1.97 x 1.97")		

Bresle Patches

Elcometer 135B Original Bresle Patches are used to determine surface chloride contamination and are self-adhesive rubber film patches with a sealed compartment for sampling soluble impurities from steel surfaces with a suitable solvent.

Elcometer 135B Bresle Patches can also be used with the Elcometer 138C Bresle Salt Kit.

Elcometer 135B



STANDARDS:
ISO 8502-6

Technical Specification

Part Number	Description
E135----B	Elcometer 135B Bresle Patches
Tests per Kit	25
Sample Volume	2.6ml ± 0.6ml
Test Area	1250mm ² , 12.5cm ² (1.93sq inches)
Dimensions	52 x 52mm (2.0 x 2.0")

Bresle Patch is a Trade Mark of SP Sveriges Tekniska Forskningsinstitut AB

• Certificate of Cleanliness & Test Area available at www.elcometer.com/cert

ENGLAND

Elcometer Limited
Manchester M43 6BU
Tel: +44 (0)161 371 6000
Fax: +44 (0)161 371 6010
sales@elcometer.com
www.elcometer.com

BELGIUM

Elcometer SA
Tel: +32 (0)4 379 96 10
Fax: +32 (0)4 374 06 03
be_info@elcometer.com
www.elcometer.be

FRANCE

Elcometer Sarl
Tel: +33 (0)2 38 86 33 44
Fax: +33 (0)2 38 91 37 66
fr_info@elcometer.com
www.elcometer.fr

GERMANY

Elcometer Instruments GmbH
Tel: +49(0)7361 52806 0
Fax: +49(0)7361 52806 77
de_info@elcometer.com
www.elcometer.de

THE NETHERLANDS

Elcometer B.V.
Tel: +31 (0)30 259 1818
Fax: +31 (0)30 210 6666
nl_info@elcometer.com
www.elcometer.nl

JAPAN

Elcometer KK
Tel: +81-(0)3-6869-0770
Fax: +81-(0)3-6433-1220
jp_info@elcometer.com
www.elcometer.jp

REPUBLIC OF SINGAPORE

Elcometer (Asia) Pte Ltd
Tel: +65 6462 2822
Fax: +65 6462 2860
asia@elcometer.com
www.elcometer.com.sg

UNITED ARAB EMIRATES

EL Inspection & Blasting
Equipment LLC
Tel: +971 4 295 0191
Fax: +971 4 295 0192
uae_sales@elcometer.com
www.elcometer.ae

USA

MICHIGAN
Elcometer Inc
Tel: +1 248 650 0500
Toll Free: 800 521 0635
Fax: +1 248 650 0501
inc@elcometer.com
www.elcometer.com

TEXAS

Elcometer of Houston
Tel: +1 713 450 0631
Toll Free: 800 521 0635
Fax: +1 713 450 0632
inc@elcometer.com
www.elcometer.com

elcometer®
www.elcometer.com

elcometer.be • elcometer.fr • elcometer.de
elcometer.nl • elcometer.jp • elcometer.com.sg

Elcometer is a registered trademark of Elcometer Limited. All other trademarks acknowledged. Due to our policy of continuous improvement, Elcometer Limited reserves the right to change specifications without notice.

© Elcometer Limited, 2017. All rights reserved. No part of this document may be reproduced, transmitted, stored (in a retrieval system or otherwise), or translated into any language, in any form, or by any means, without the prior written permission of Elcometer Limited.